

Hook and Mini hook



Ideal for attaching directly to existing clips, brackets, light fittings and signage.

PRODUCT INFORMATION

- Quick and easy attachment to cable basket, purlin clips, light fittings
- Available up to 200 lbs SWL, with a 5:1 safety factor
- Comes as a ready-to-use kit with cable and Gripple fastener
- Available in lengths from 5 - 30 ft
- Other lengths are available on request

HOOK



MINI HOOK



INSTALLATION

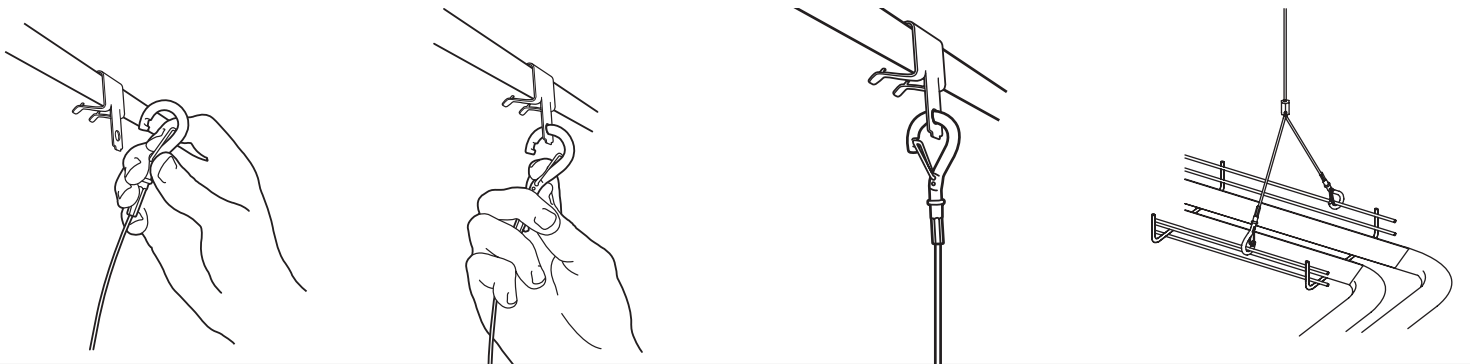

PRODUCT DIMENSIONS

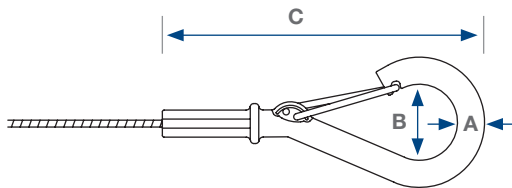

Size		A (in)	B (in)	C (in)
No.1 (25 lbs)	Mini	3/16"	1/4"	2 3/16"
	Large	1/4"	5/8"	3"
No.2 (100 lbs)	Large	1/4"	5/8"	3"
No.3 (200 lbs)	Large	1/4"	5/8"	3"

IMPORTANT INFORMATION

1. Construction materials and conditions vary on different sites. If it is suspected that the base material has insufficient strength to achieve a suitable fixing, contact Gripple Inc. The responsibility for judgement of base material strength lies with the installer, and not with Gripple Inc.
2. The information and recommendations given herein are believed to be correct at time of writing. The data has been obtained from tests done under laboratory, or other controlled conditions and it is the users responsibility to use the data given in light of conditions on site, taking account of the intended use of the products concerned.
3. While Gripple Inc can give general guidance and advice, the nature of Gripple products means that the ultimate responsibility for selecting the correct product for a particular application must lie with the customer.
4. All products must be used, handled and applied in accordance with current product instructions and manufacturers recommendations for use, published by Gripple Inc.
5. Gripple's policy is one of continuous development and innovation. We therefore reserve the right to alter specifications, etc. without notice.